

OPERATOR'S MANUAL BELT/DISC FINISHING SANDER MODEL GRIT 15



THANK YOU FOR BUYING A GRIT 15 BELT/DISC FINISHING SANDER

Your new Belt/Disc Sander has been engineered and manufactured to HTEK Solutions high standards for dependability, ease of operation, and operator safety. Properly cared for, it will give you years of rugged, trouble-free performance.



CAUTION: Carefully read through this entire operator's manual before using your new machine.

Pay close attention to the Rules for Safe Operation, Warnings, and Cautions. If you use your machine properly and only for what it is intended, you will enjoy years of safe, reliable service.

Thank you again for buying HTEK tools.

SAVE THIS MANUAL FOR FUTURE REFERENCE

TABLE OF CONTENTS

■ Product Specifications	2
■ Rules for Safe Operation	3-5
■ Unpacking and Loose Parts	6
■ Features	7
■ Operation	8
■ Parts Ordering/Service	9

PRODUCT SPECIFICATIONS

Belt Size	(50 mm) x (2000 mm)	Table Size	350mm
Belt Speed	ADJUSTABLE	Table Tilt	0°
Belt Tilt	0°-90°	Input	240V AC, 50Hz,
Disc Size	6 in. (152.4 mm)	Motor	1100W
Disc Speed	500-3600 RPM	Net Weight	104kg



Look for this symbol to point out important safety precautions. It means attention!!! Your safety is involved.



WARNING:



The operation of any power tool can result in foreign objects being thrown into your eyes, which can result in severe eye damage. Before beginning tool operation, always wear safety goggles or safety glasses with side shields and a full face shield when needed. We recommend Wide Vision Safety Mask for use over eyeglasses or standard safety glasses with side shields. Always wear eye protection which is marked to comply with ANSI Z87.1.

RULES FOR SAFE OPERATION

Safe operation of this power tool requires that you read and understand this operator's manual and all labels affixed to the tool. Safety is a combination of common sense, staying alert, and knowing how your tool works.

READ ALL INSTRUCTIONS

- **KNOW YOUR POWER TOOL.** Read the operator's manual carefully. Learn its applications and limitations as well as the potential hazards.
- **GUARD AGAINST ELECTRICAL SHOCK** by preventing body contact with grounded surfaces such as pipes, radiators, ranges, refrigerator enclosures.
- **KEEP GUARDS IN PLACE** and in good working order.
- **REMOVE ADJUSTING KEYS AND WRENCHES.** Get in the habit - before turning on tool - that hex keys and adjusting wrenches are removed from tool.
- **KEEP THE WORK AREA CLEAN.** Cluttered work areas and work benches invite accidents. **DO NOT** leave tools or pieces of wood on the machine while it is in operation.
- **DO NOT USE IN DANGEROUS ENVIRONMENTS.** Do not use power tools near gasoline or other flammable liquids, in damp or wet locations, or expose them to rain. Keep the work area well lighted.
- **KEEP CHILDREN AND VISITORS AWAY.** All visitors should wear safety glasses and be kept a safe distance from work area. Do not let visitors contact tool or extension cord while operating.
- **MAKE WORKSHOP CHILDPROOF** with padlocks and master switches or by removing starter keys.
- **DO NOT FORCE THE TOOL** it will do the job better and safer at the rate for which it was designed.
- **USE THE RIGHT TOOL FOR THE JOB.** Do not force the tool or attachment to do a job for which it was not designed for. Use it only the way it was intended.
- **USE THE PROPER EXTENSION CORD.** Make sure your extension cord is in good condition. Use only a cord heavy enough to carry the current your product will draw. An undersized cord will cause a drop in line voltage resulting in loss of power and overheating. A wire gage size (A.W.G.) of at least **16** is recommended for an extension cord 25 feet or less in length. If in doubt, use the next heavier gage. The smaller the gage number, the heavier the cord.
- **DRESS PROPERLY.** Do not wear loose clothing, gloves, neckties, rings, bracelets, or other jewelry that could get caught and draw you into moving parts. Non-slip footwear is recommended. Wear protective covering over long hair.
- **ALWAYS WEAR SAFETY GLASSES WITH SIDE SHIELDS.** Everyday eyeglasses have only impact resistant lenses; they are **not** safety glasses.
- **PROTECT YOUR LUNGS.** Wear a face or dust mask if the operation is dusty.
- **PROTECT YOUR HEARING.** Wear hearing protection during extended periods of operation.
- **SECURE WORK.** Use clamps or a vise to hold the work when practical. It's safer than using your hand and frees both hands to operate the tool.
- **DO NOT OVERREACH.** Keep proper footing and balance at all times.
- **MAINTAIN TOOLS WITH CARE.** Keep tools sharp and clean for better and safer performance. Follow instructions for lubricating and changing accessories.
- **DISCONNECT ALL TOOLS.** When not in use, before servicing, or when changing attachments, all tools should be disconnected.
- **AVOID ACCIDENTAL STARTING.** Be sure switch is off when plugging in any tool.
- **USE RECOMMENDED ACCESSORIES.** Consult this operator's manual for recommended accessories. The use of improper accessories may cause risk of injury.
- **NEVER STAND ON TOOL.** Serious injury could occur if the tool is tipped or if the sanding belt or disc is unintentionally contacted.
- **CHECK DAMAGED PARTS.** Before using the tool, a guard or other part that is damaged should be carefully checked to determine that it will operate properly and perform its intended function. Check for alignment of moving parts, binding of moving parts, breakage of parts, mounting and any other conditions that may affect operation. A guard or other part that is damaged must be properly repaired or replaced by an authorized service center to avoid risk of personal injury.
- **NEVER LEAVE TOOL RUNNING UNATTENDED, TURN THE POWER OFF.** Do not leave tool until it comes to a complete stop.
- **DO NOT ABUSE CORD.** Never yank the cord to disconnect it from the receptacle. Keep the cord from heat, oil, and sharp edges.
- **KEEP HANDS AWAY FROM WORK AREA.** Keep hands away from the work area. Restrain any loose clothing, jewelry, long hair, etc. that may become entangled in the tool.
- **KEEP TOOL DRY, CLEAN, AND FREE FROM OIL AND GREASE.** Always use a clean cloth when cleaning. Never use brake fluids, gasoline, petroleum-based products, or any solvents to clean tool.
- **STAY ALERT AND EXERCISE CONTROL.** Watch what you are doing and use common sense. **Do not operate tool when you are tired. Do not rush.**
- **DO NOT USE TOOL IF SWITCH DOES NOT TURN IT ON AND OFF.** Have defective switches replaced by an authorized service center.

RULES FOR SAFE OPERATION

- **ALWAYS TURN SWITCH OFF** before disconnecting it to avoid accidental starting.
- **ALL REPAIRS, WHETHER ELECTRICAL OR MECHANICAL**, should be made at a HTEK Authorized Service Center. Use only HTEK identical replacement parts.
- **SAVE THESE INSTRUCTIONS.** Refer to them frequently and use to instruct other users. If you loan someone this tool, loan them these instructions also.

WARNING:

Some dust created by power sanding, sawing, grinding, drilling, and other construction activities contains chemicals known to cause cancer, birth defects or other reproductive harm. Some examples of these chemicals are:

- lead from lead-based paints,
- crystalline silica from bricks and cement and other masonry products, and
- arsenic and chromium from chemically-treated lumber.

Your risk from these exposures varies, depending on how often you do this type of work. To reduce your exposure to these chemicals: work in a well ventilated area, and work with approved safety equipment, such as those dust masks that are specially designed to filter out microscopic particles.

SAVE THESE INSTRUCTIONS

The purpose of safety symbols is to attract your attention to possible dangers. The safety symbols, and the explanations with them, deserve your careful attention and understanding. The safety warnings do not by themselves eliminate any danger. The instructions or warnings they give are not substitutes for proper accident prevention measures.

SYMBOL

MEANING



SAFETY ALERT SYMBOL:

Indicates danger, warning, or caution. May be used in conjunction with other symbols or pictographs.



DANGER: Failure to obey a safety warning will result in serious injury to yourself or to others. Always follow the safety precautions to reduce the risk of fire, electric shock and personal injury.



WARNING: Failure to obey a safety warning can result in serious injury to yourself or to others. Always follow the safety precautions to reduce the risk of fire, electric shock and personal injury.



CAUTION: Failure to obey a safety warning may result in property damage or personal injury to yourself or to others. Always follow the safety precautions to reduce the risk of fire, electric shock and personal injury.

NOTE:

Advises you of information or instructions vital to the operation or maintenance of the equipment.

RULES FOR SAFE OPERATION

IMPORTANT

Servicing requires extreme care and knowledge and should be performed only by a qualified service technician. For service we suggest you return the tool to your nearest HTEK SOLUTIONS for repair. When servicing, use only identical HTEK replacement parts.

WARNING:

Observe all normal safety precautions related to avoiding electrical shock.

WARNING:

Do not attempt to operate this tool until you have read thoroughly and understand completely all instructions, safety rules, etc. contained in this manual. Failure to comply can result in accidents involving fire, electric shock, or serious personal injury. Save this operator's manual and review frequently for continuing safe operation and instructing others who may use this tool.

SAFETY AND INTERNATIONAL SYMBOLS

This operator's manual describes safety and international symbols and pictographs that may appear on this product. Read the operator's manual for complete safety, assembly, operating and maintenance, and repair information.



MEANING

Do not expose to rain or use in damp locations



DO NOT reach across the sanding disc to turn the belt/disc sander **ON** or **OFF**. Contact with the sanding disc can result in serious personal injury.

Work ergonomics

You can find this document in a separate attachment.



CAUTION !!!!

IF YOU USE WATER COOLING SYSTEM,
USE ONLY WATERPROOF SANDBELT!!!

CAUTION !!!!

Empty the spark box regularly. Metal particles
burn with smolder



Disc & Belt Sanders Safety Rules

Do not operate sanders without the guards in place.

On the disc sander always use the downward motion side of the disc to sand. Never the upward motion side as this can throw your part upwards with tremendous force.

Always attempt to place your work against the rest on the disc and belt sanders.

On the horizontal belt sander, always sand, so that the belt motion is away from you.

Do not operate machines with torn or ripped belts or disks.

Do not sand any material that will give off a dangerous dust. Such materials as beryllium or copper beryllium alloys must not be sanded or filed. Asbestos must not be sanded. Asbestos is an ingredient of brake shoes and pads.

Safety goes beyond a set of information and rules to memorize. Safety is a culture. You live it by learning it, and learn it by living it ... so that you and others can go on living. SAFETY is very important!

UNPACKING

Your belt/disc sander has been shipped completely assembled except for the sanding disc, disc guard, miter gauge, work support, and worktable.

- Carefully remove all parts from the shipping carton.
- Do not discard the packing material until you have carefully inspected the belt/disc sander, identified all parts, and satisfactorily operated your new tool.
- If all parts have been included, proceed to assembly.
- If any parts are damaged or missing, please call +358445885080 for assistance.
- Examine all parts to make sure no breakage has occurred during shipping. Any damaged or missing part should be replaced before attempting to use the tool.

Note: If any parts are damaged or missing, do not attempt to plug in the power cord and turn the switch on until the damaged or missing parts are obtained and are installed correctly.

WARNING:

Do not allow familiarity with your belt/disc sander to make you careless. Remember that a careless fraction of a second is sufficient to inflict severe injury.

WARNING:

Do not attempt to assemble the belt/disc sander, plug in the power cord, or turn on switch if any parts are damaged or missing. Failure to heed this warning could result in serious personal injury.

LOOSE PARTS

Check all loose parts with the list below. Assemble according to the instructions on the following pages.

- Sanding Disc



Sanding/finishing DISC

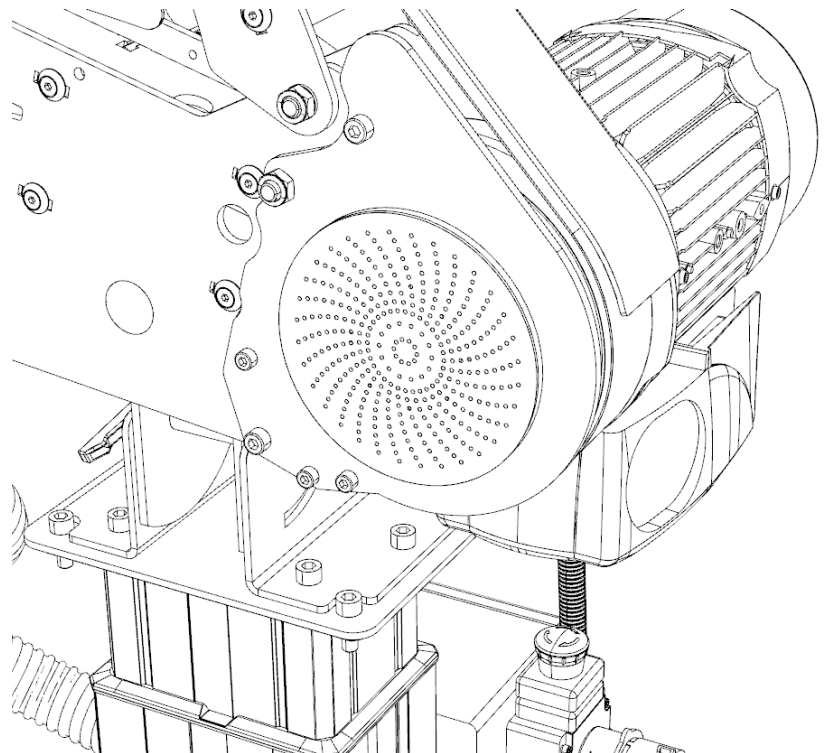

Fig. 2

FEATURES

KNOW YOUR BELT/DISC SANDER

See Figure 3.

Before attempting to use your belt/disc sander, familiarize yourself with all the operating and safety requirements.

BELT TENSION LEVER

The belt tension lever releases the belt tension for easy belt replacement.

HORIZONTAL AND VERTICAL POSITION HOLES

The horizontal and vertical position holes are used for changing the position of the belt from horizontal to vertical.

SANDING BELT

The sanding belt can be adjusted from horizontal to vertical providing different positions for sanding workpieces of different shapes and sizes.

SANDING DISC

A round sanding disc located on the side of the belt/disc sander.

SWITCH AND SWITCH

Your disc/belt sander has an easy access power switch. To lock in the **OFF** position, remove the switch key.

OPERATION PANEL

SEE PICTURE !! DO NOT TOUCH/ADJUST ANYTHING ELSE !!

WORK SUPPORT

Supports the workpiece on the sanding belt.

WORKTABLE

Equipped with a sturdy, worktable that provides a stable surface when using either the disc sanding or the belt sanding feature.

Part list next page figure 8.

Parts list

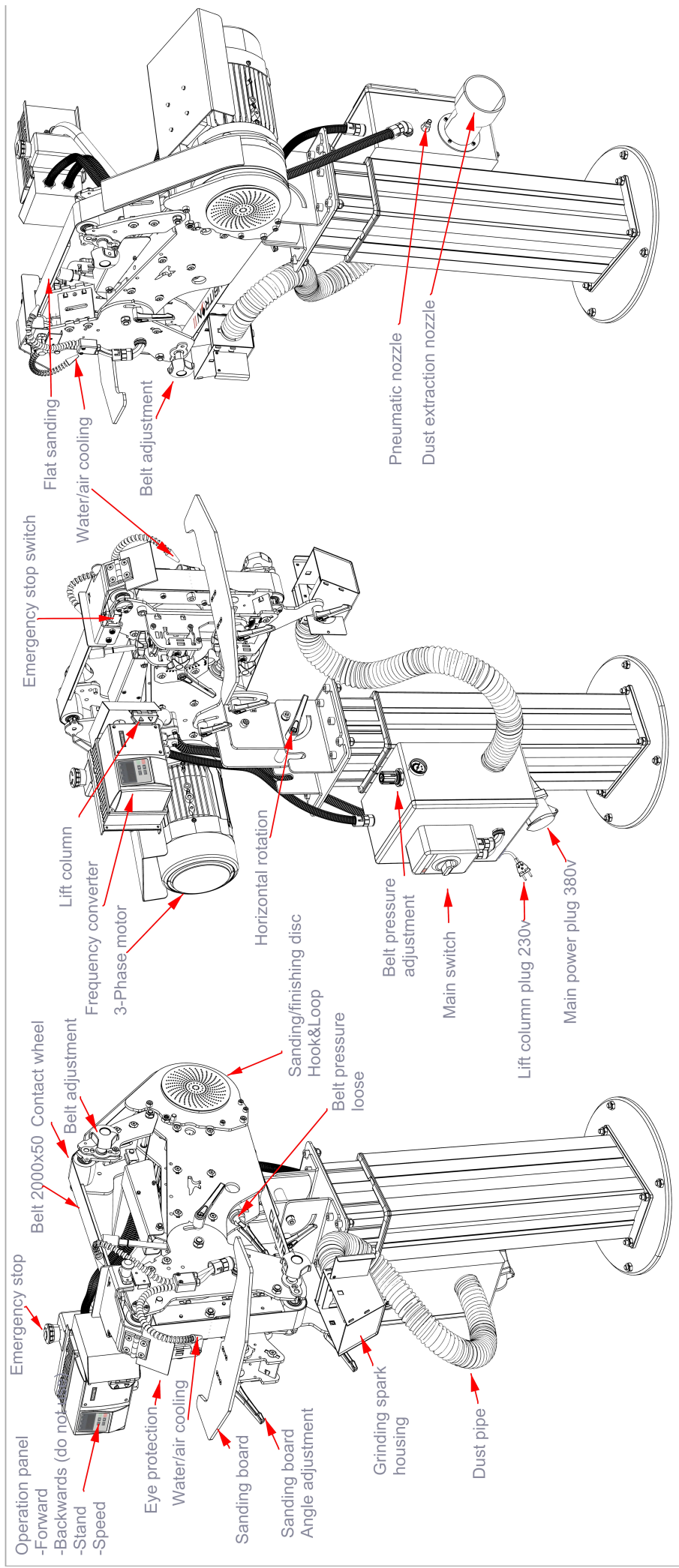

Machine operation

1. Connect the power cables. 3-phase and 1-phase cables for the lifting column

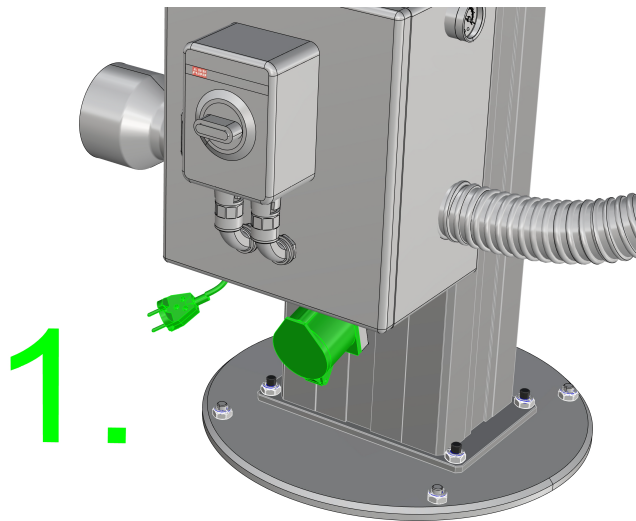

2. Turn the safety switch to the ON position

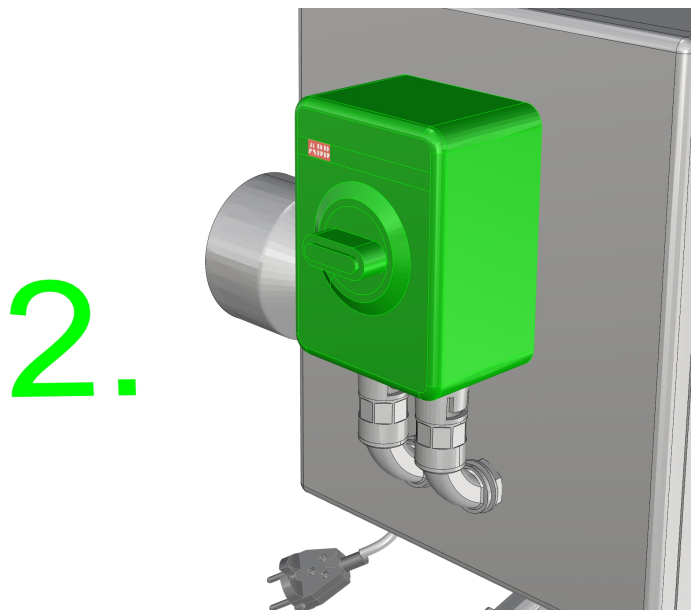



1. Find the frequency in the operation button (F)

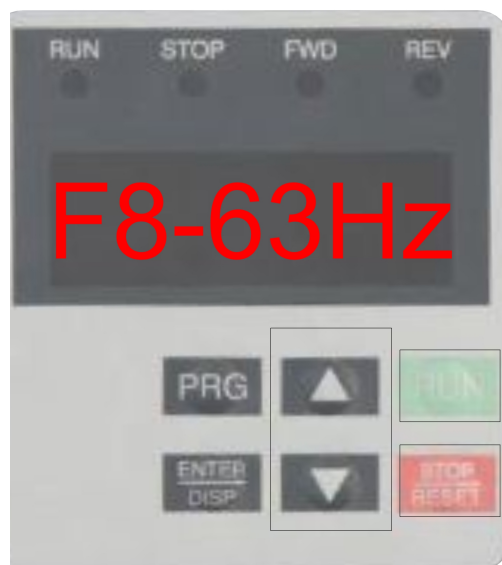

1. Adjust the frequency F (motor revolutions) with the arrow keys (up<>down)
2. RUN starts the machine
3. STOP the machine



BEFORE STARTING THE MACHINE, MAKE SURE THAT THE SANDING BELT IS INSERTED INTO PLACE!!!

Sanding belt release

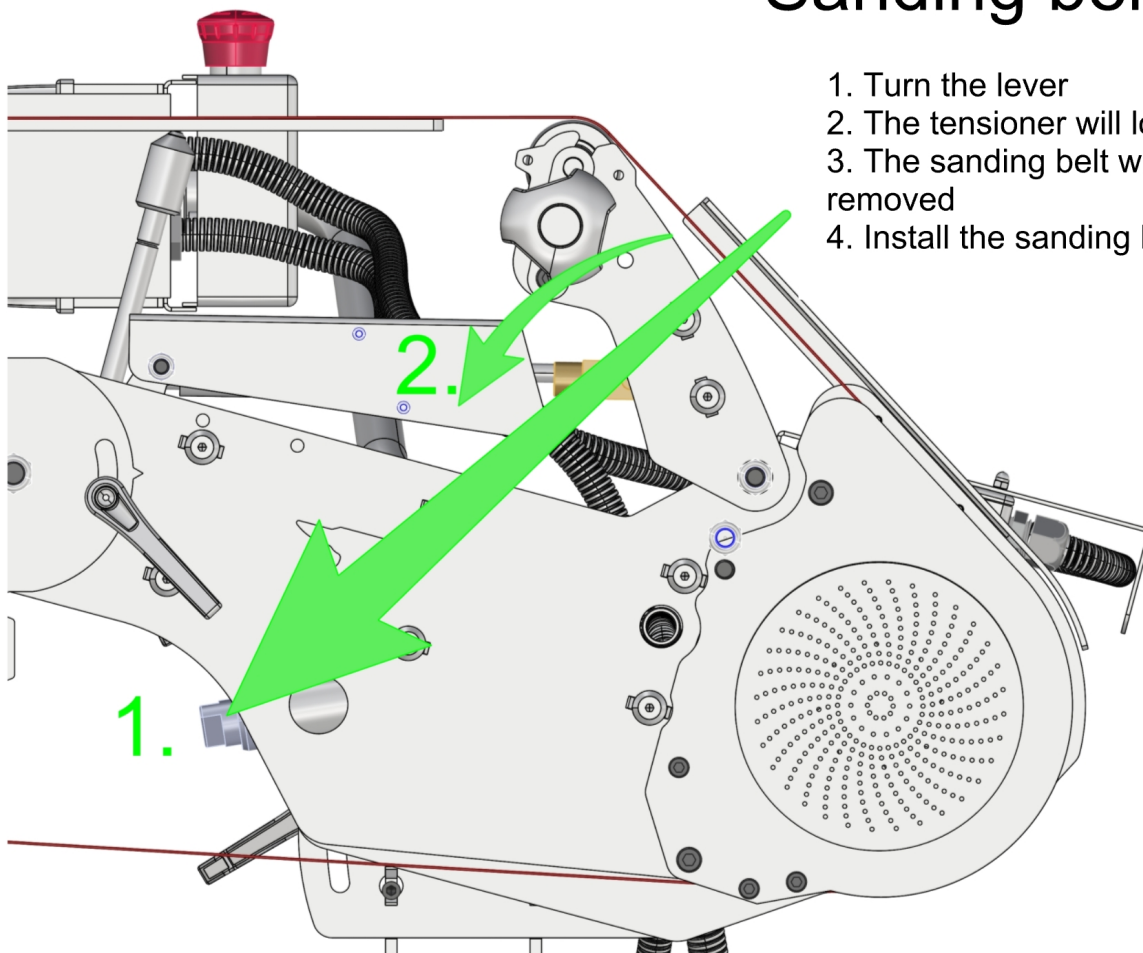

1. Turn the lever
2. The tensioner will lower
3. The sanding belt will loosen and can be removed
4. Install the sanding belt in reverse order

Adjust the tension of the sanding belt with air pressure. The adjustment range is 2-5bar. Do not put over 5bar !!

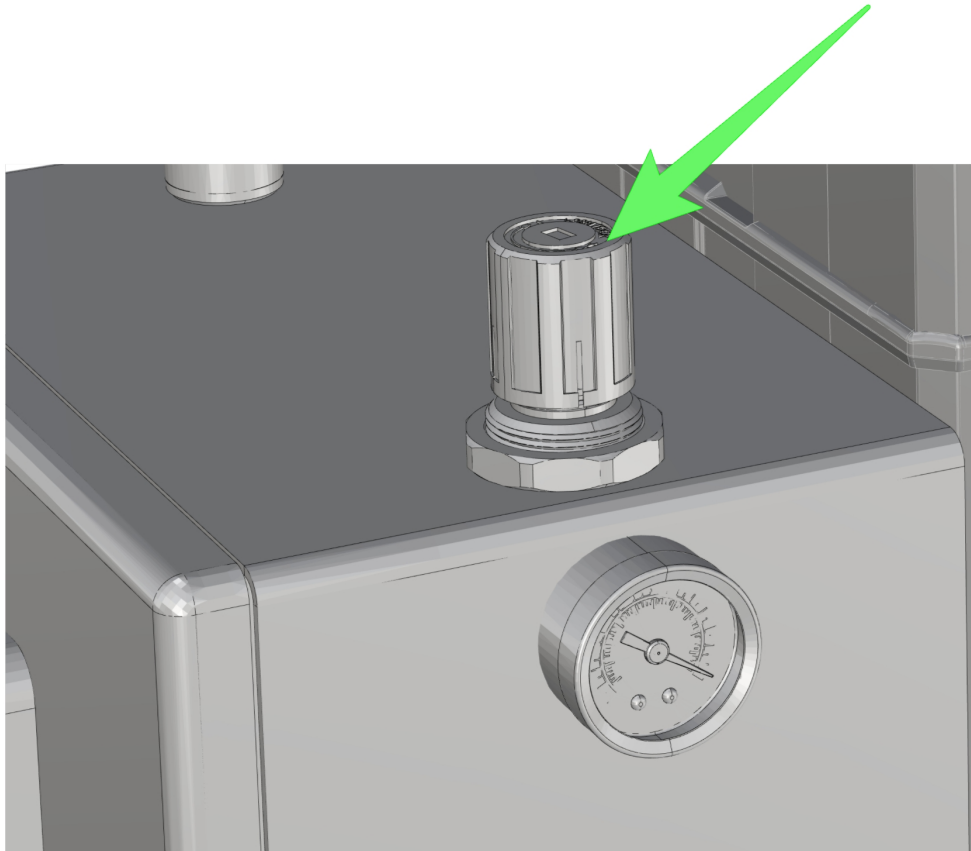

The wiring diagram:

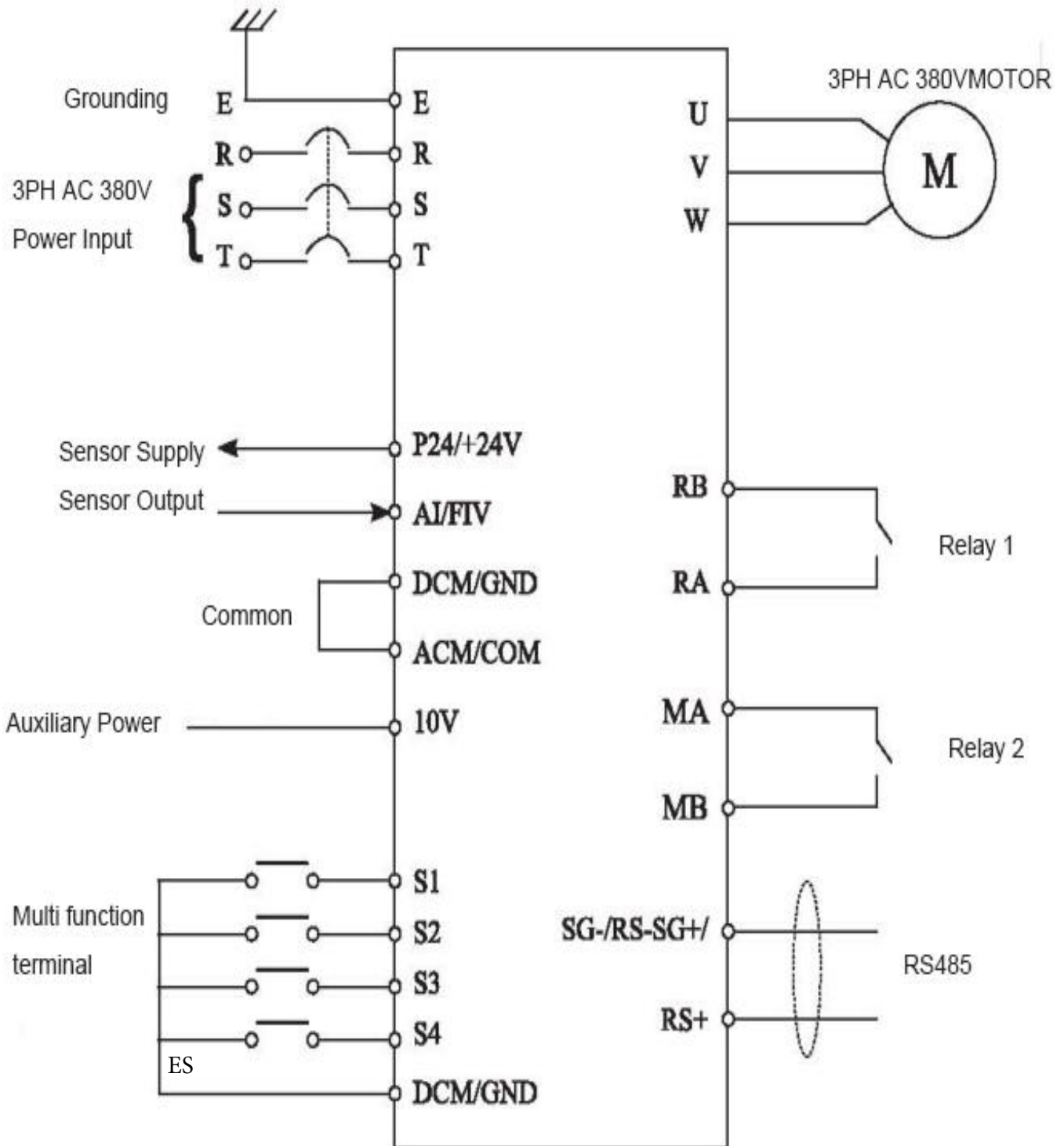

CE CONFORMITY

This belt sander GRIT 15 complies with the following EU directives and standards:

2006/42/EC (Machinery Directive) – Safety of machinery

2014/35/EU (Low Voltage Directive) – Electrical safety

2014/30/EU (EMC Directive) – Electromagnetic compatibility

EN ISO 12100 – Safety of machinery, risk assessment

EN 60204-1 – Electrical equipment of machinery

We hereby declare that this product complies with the above-mentioned safety and performance requirements.

The CE marking is located on the body of the device and indicates the product's compliance with EU regulations.

If changes are made to the device that affect its safety or performance, the manufacturer's liability for compliance with CE requirements will lapse.

HTEK Solutions

Address: Kullervonkatu 2, 70780 Kuopio, Finland

Date: 22.2.2025

Signature: HTEK Solutions

OPERATOR'S MANUAL

Belt/Disc Sander Model

GRIT 15

EXTENSION CORD CAUTION

When using a power tool at a considerable distance from a power source, be sure to use an extension cord that has the capacity to handle the current the tool will draw. An undersized cord will cause a drop in line voltage, resulting in overheating and loss of power. Use the chart to determine the minimum wire size required in an extension cord. Only round jacketed cords should be used.

When working with a tool outdoors, use an extension cord that is designed for outside use. This is indicated by the letters "WA" on the cord's jacket.

Before using any extension cord, inspect it for loose or exposed wires and cut or worn insulation.

HTEK Solution uses high-quality materials.

Grit belt sander motors are made by Machtric and Moves. The motors have overheating protections and are classified according to LVD in the CE category.

Engine information and datasheet can be found with the machine delivery.



• SERVICE

Now that you have purchased your tool, should a need ever exist for repair parts or service, simply contact your nearest HTEK Solutions Service Center. You can also check our website at www.htek.fi

• MODEL NO.

The model and serial numbers of your tool will be found on the data plate attached to the tool. Please record the serial number in the space provided below.

- MODEL NUMBER GRIT 15-0012
- SERIAL NUMBER 10109

